

**INTERSECTING CURB RAMPS
AT VEHICULAR WAYS**

A

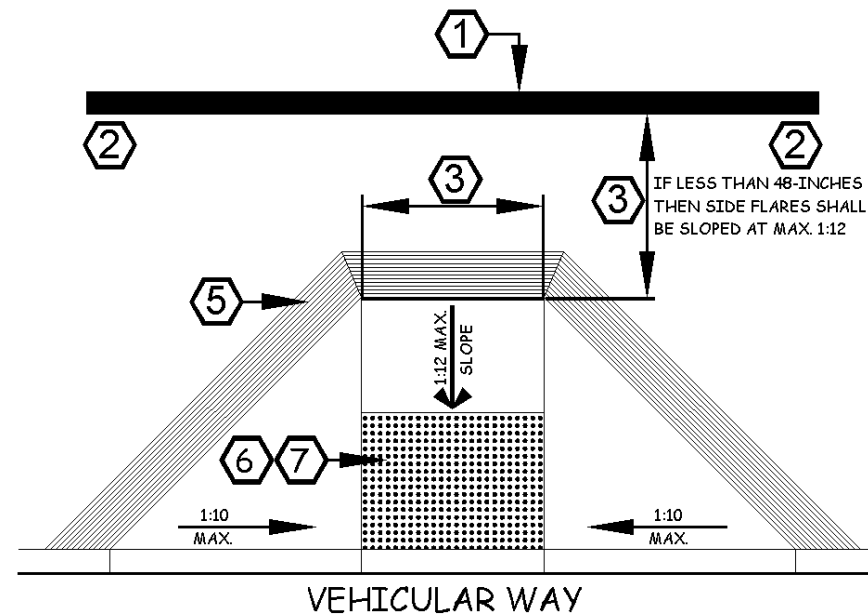

**CURB RAMP PERPENDICULAR
TO VEHICULAR WAY**

B

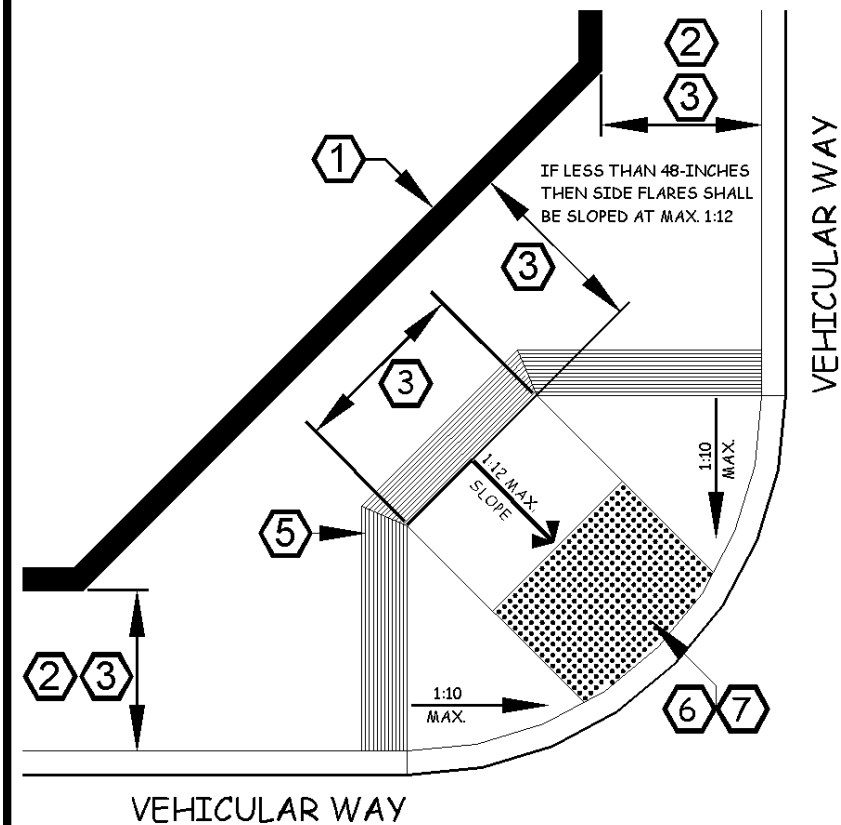

**DIAGONAL CURB RAMP
AT VEHICULAR WAYS**

C

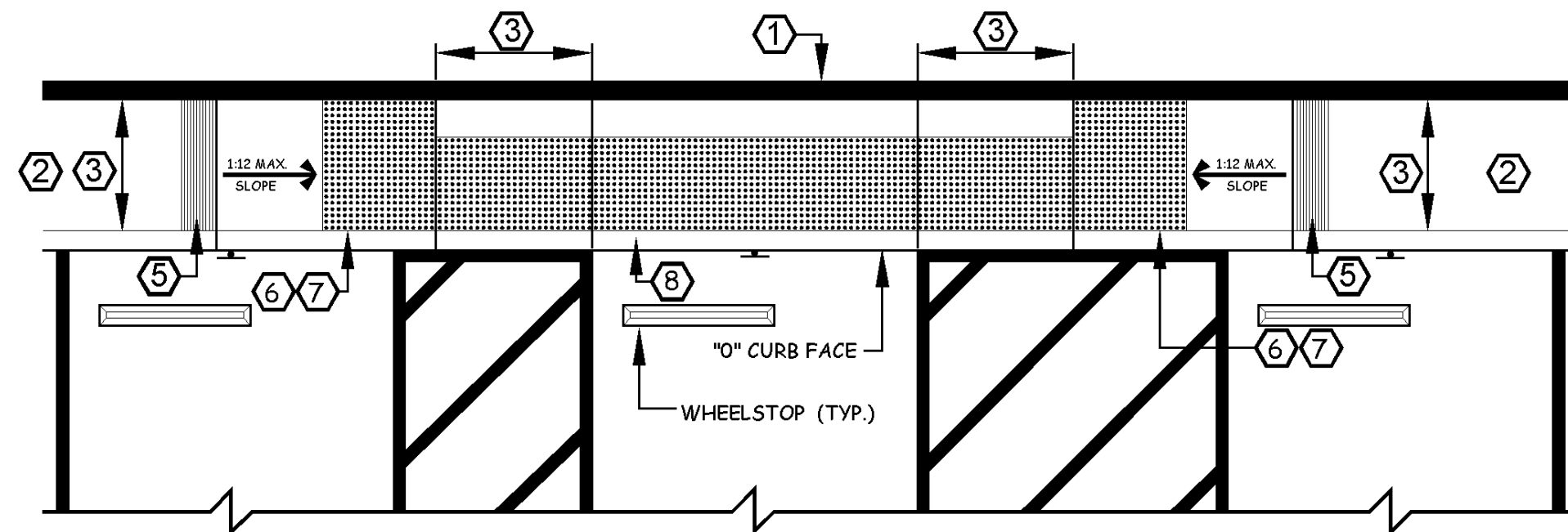

CURB RAMPS @ ACCESSIBLE PARKING AREAS

D

KEYNOTES

- 1 WALL, FENCE, LANDSCAPING OR OTHER OBSTRUCTION.
- 2 ACCESSIBLE ROUTE OF PEDESTRIAN TRAVEL.
- 3 48-INCH MINIMUM
- 4 MAY BE LESS THAN 60-INCHES BUT NOT LESS THAN 48-INCHES.
- 5 12-INCH MINIMUM BORDER GROOVES @ 3/4-INCH O/C. GROOVES MUST BE POSITIONED ON THE LEVEL SURFACE AT THE TOP OF THE CURB RAMP.
- 6 SLOPE OF CURB RAMPS SHALL NOT EXCEED (1) UNIT VERTICAL TO (12) UNITS HORIZONTAL (1:12 or 8.33%).
- 7 TRUNCATED DOMES SHALL EXTEND 36 INCHES MINIMUM IN THE DIRECTION OF TRAVEL FOR THE FULL WIDTH OF CURB RAMP, EXCLUDING THE FLARED SIDES.
- 8 A MINIMUM 36-INCH WIDE SECTION OF TRUNCATED DOMES SHALL BE PROVIDED WHEN FLAT TRAVEL SURFACE ADJOINS A VEHICULAR WAY ("0" CURB FACE).

E

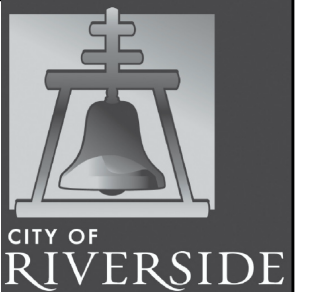

City of Riverside
Building & Safety Division
DISABLED ACCESS STANDARDS

SCALE NONE

PGH 01 / 08
DRAWN DATE

REV.	DATE	APPR.
1	01-01-11	PGH
2	08-01-12	PGH
3		
4		
5		

**DETECTABLE
WARNINGS @
CURB RAMPS**

RDA - 8.0

SHEET